

---

# Comfort that lasts

Aviera®



SitOnIt • Seating®



# Take a seat (with confidence)



Reliability runs in the family

---

Every Aviera model shares the same value-driven DNA:  
built to be durable, engineered to be flexible,  
designed to be customizable and created to be comfortable.



Whether lobby, lounge, welcoming or waiting, you can rest easy with supremely comfortable do-it-all seating for your public spaces. Aviera makes it easy to configure endlessly and effortlessly – across an entire collection – with worry-free design and lasting durability, including metal or wood frames that feature an integrated steel structure. Discover an industry-leading seating solution and get peace-of-mind for any project.



## Outperform and outlast

Aviera outshines with a uniquely-beveled frame and sturdy steel structure, with metal-to-metal connections, that can endure sit after sit – day after day. And if any part needs a refresh, its modular assembly means each piece is field-replaceable for a quick-and-easy fix.

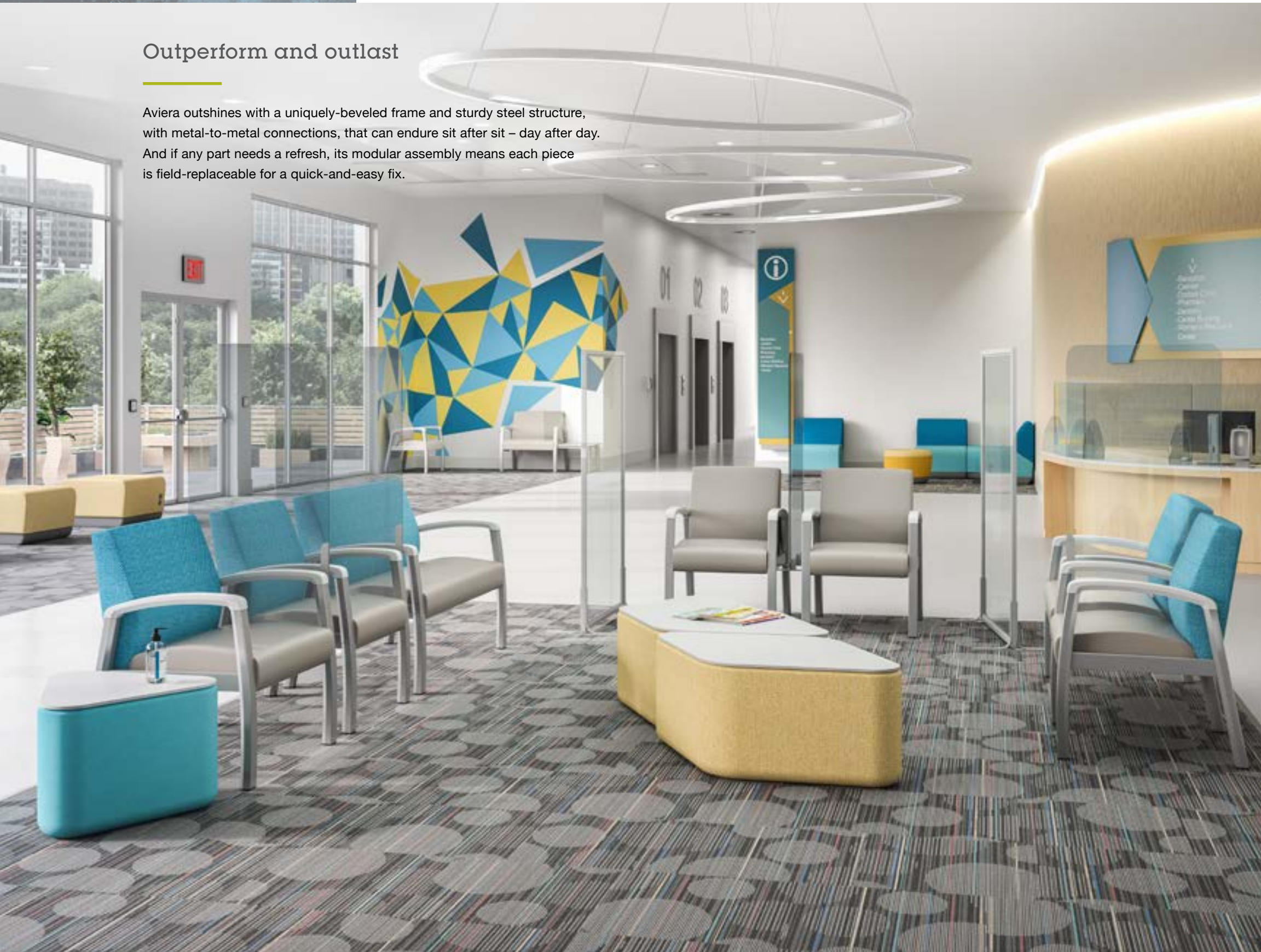

## Safe and sound design

It's easy to get into (and out of) this healthcare hero when you have Healthier Hospital compliant options, non-skid footrests on all hip chairs, non-corrosive aluminum frames, silver ion anti-microbial wood frames, ample clean-out spaces, wall-saving frames and arched arm rests.

**AVIERA TEXTILE:** SitOnIt Seating Sili-Tex Sterling (seat), SitOnIt Seating Huntington Splash (back)  
**NANO TEXTILE:** SitOnIt Seating Newport Aqua (chassis); SitOnIt Seating Monterey Glow (chassis)

**PASÉA BENCHES TEXTILE:** SitOnIt Seating Monterey Glow  
**PASÉA LOUNGE TEXTILES:** SitOnIt Seating Newport Aqua (seat), SitOnIt Seating Cue Electric Blue (back)  
**PASÉA OTTOMANS TEXTILE:** SitOnIt Seating Newport Lemon (chassis), SitOnIt Seating Monterey Glow (top)





## Any space or place

From freespanning to freestanding, preconfigured and more, this collection provides a wide variety of chairs and coordinating tables to fit any area or application.



High-density foam with waterfall edge



Power ports (optional)



Wall-saving frame

## Feature comforts

From corporate receptions to hospitality lounges, good things can come to those who wait when they relax and recharge on supremely comfortable dual-density foam cushions – with waterfall curve – and convenient power ports (optional).

**RIO PLASTIC:** Fire & Tangerine  
**PASÉA TEXTILE:** SitOnIt Seating Cue Fog (seat),  
 SitOnIt Seating Strive Smoky (back)  
**PASÉA OTTOMAN TEXTILES:** SitOnIt Seating Cue Fog (seat),  
 SitOnIt Seating Cue Tangerine (chassis)

**MOVI TEXTILE:** SitOnIt Seating Motion Graphite (seat), Electric Blue Mesh (back)  
**VECTRA TEXTILE:** SitOnIt Seating Huntington Tropical (seat), Onyx Mesh (back)  
**AVIERA TEXTILE:** SitOnIt Seating Monterey Flurry (seat), SitOnIt Seating Monterey Citrus (back)



## Let's talk textiles

Settle into custom comfort and not on choice with the biggest textile program in the industry. Choose from over 15,000 options graded-in (and 1,000+ ready to ship within 10 days), including moisture barrier, dual upholstery and PatternMatch® options.

## A closer look

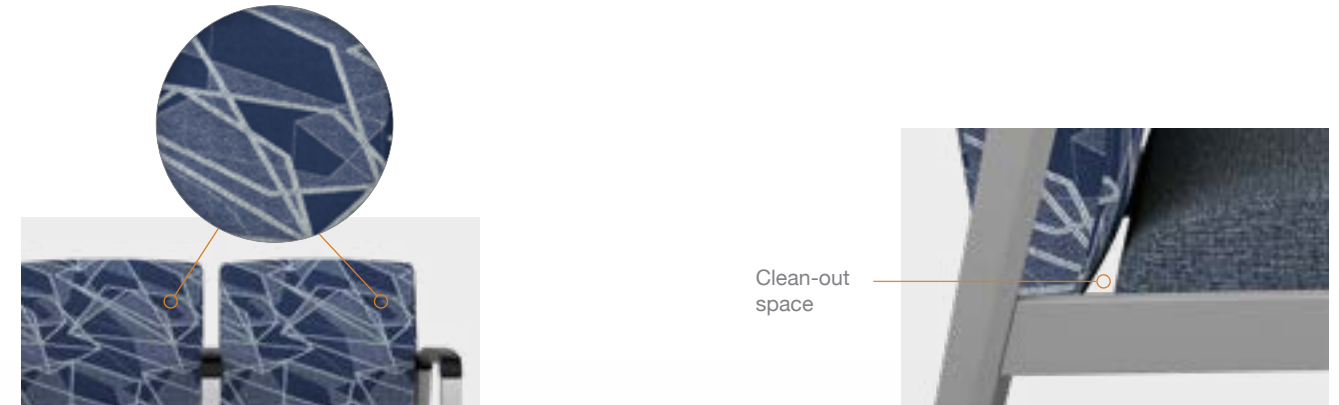

PatternMatch® lines up patterns on each chair component

Clean-out space

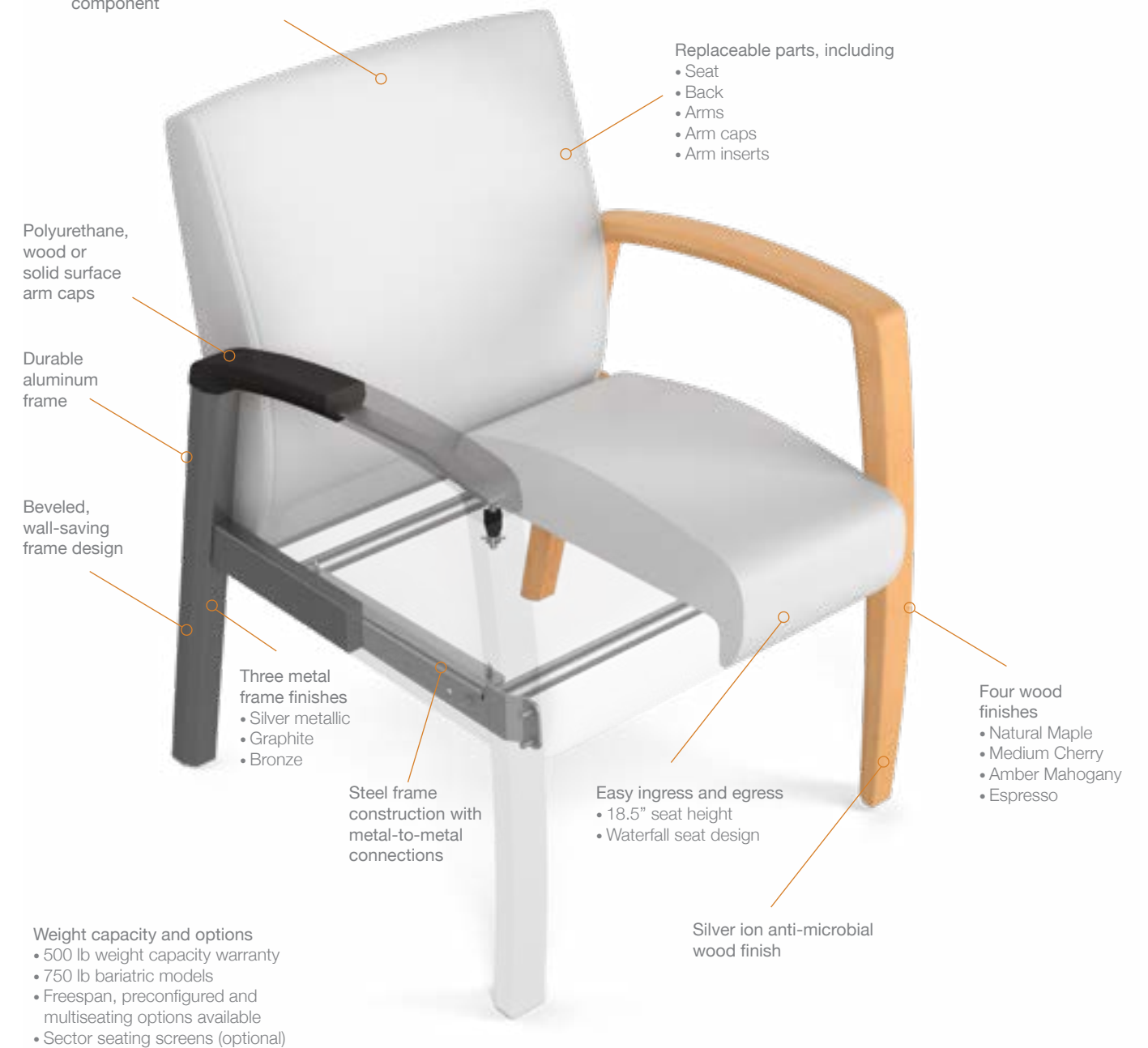

Replaceable parts, including

- Seat
- Back
- Arms
- Arm caps
- Arm inserts

Polyurethane, wood or solid surface arm caps

Durable aluminum frame

Beveled, wall-saving frame design

Three metal frame finishes

- Silver metallic
- Graphite
- Bronze

Steel frame construction with metal-to-metal connections

Easy ingress and egress

- 18.5" seat height
- Waterfall seat design

Silver ion anti-microbial wood finish

Four wood finishes

- Natural Maple
- Medium Cherry
- Amber Mahogany
- Espresso

Weight capacity and options

- 500 lb weight capacity warranty
- 750 lb bariatric models
- Freespan, preconfigured and multiseating options available
- Sector seating screens (optional)



# Finishes

## METAL FRAME



Silver Metallic

Taupe

Graphite

## WOOD FRAME



Clear Maple

Medium Cherry

Amber Mahogany

Espresso

Stain-to-Match

## POLYURETHANE ARM CAP



Fog

Dark Grey

Black

## WOOD ARM CAP (Aviera Metal Only)



Clear Maple

Medium Cherry

Amber Mahogany

Espresso

Stain-to-Match

## SOLID SURFACE ARM CAP (Aviera Metal Only)



Designer White

## OPTIONAL USB POWER



# Tables

## LINKING TABLES

Specify in wood veneer, solid surface or laminate tops with wood or metal legs.



### Center

Width 22"  
Depth 22"  
Height 16"  
Weight 17.5 lb

### End

Width 21"  
Depth 22"  
Height 16"  
Weight 17.5 lb

### Round 90° Corner

Width 31"  
Depth 31"  
Height 16"  
Weight 33 lb

### Square 90° Corner

Width 28.4"  
Depth 28.4"  
Height 16"  
Weight 33 lb

## WOOD FINISHES



Clear Maple

Medium Cherry

Amber Mahogany

Espresso

Stain-to-Match

## LAMINATE FINISHES & POLYMER EDGE COLORS



Slate

Khaki Brown

Fusion Maple

Fonthill Pear

Huntington Maple



Shaker Cherry (Laminate)

Brighton Walnut

Cafelle

Black

Mocha (Polymer Edge)

## SOLID SURFACE FINISHES

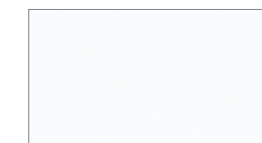

Designer White

# Specifications



Guest 21"      Guest 24"      Guest 30"      Guest 44"

SPECIFICATIONS	21"	24"	30"	44"
Dimensions are in inches				
Overall Height	34.5	34.5	34.5	34.5
Overall Width	24.5	27.5	33.5	47.5
Overall Depth	26.5	26.5	26.5	26.5
Arm Height (height of arms from floor)	25.75	25.75	25.75	25.75
Arm Height (arm height from seat to top of arm)	7.25	7.25	7.25	7.25
Width Between Arms	20.75	23.75	29.75	43.75
Seat Width	21.75	24.75	30.75	44.75
Seat Depth	19	19	19	19
Seat Height	18.5	18.5	18.5	18.5
Back Height	18.5	18.5	18.5	18.5
Weight (wood)	33 lb	35 lb	45 lb	72 lb
Weight (metal)	38 lb	40 lb	50 lb	77 lb
Weight Capacity	350 lb (wood) 500 lb (metal)	350 lb (wood) 500 lb (metal)	750 lb	750 lb
COM* (back & seat) (with upholstered arm insert)	1.9 yd 2.5 yd	1.9 yd 2.8 yd	3.1 yd 3.1 yd	3.4 yd 4.1 yd
COL* (back & seat) (with upholstered arm insert)	29.4 sq ft 37.8 sq ft	43.4 sq ft 57.4 sq ft	47.6 sq ft 47.6 sq ft	50.4 sq ft 63 sq ft

\* Yardage requirements for COM and COL are for solid and non-directional fabrics. Additional material may be required for larger repeating patterns. Contact Customer Experience.



Hip Chair

SPECIFICATIONS	
Dimensions are in inches	
Overall Height	40.25
Overall Width	24.5
Overall Depth	28.25
Arm Height (height of arms from floor)	31.75
Arm Height (arm height from seat to top of arm)	7.25
Width Between Arms	20.75
Seat Width	21.75
Seat Depth	19
Seat Height	24.5
Back Height	18.5
Foot Rest Height (from floor)	7.0
Weight (wood)	33 lb
Weight (metal)	38 lb
Weight Capacity	350 lb (wood) 500 lb (metal)
COM* (back & seat) (with upholstered arm insert)	1.9 yd 2.5 yd
COL* (back & seat) (with upholstered arm insert)	29.4 sq ft 37.8 sq ft

\* Yardage requirements for COM and COL are for solid and non-directional fabrics. Additional material may be required for larger repeating patterns. Contact Customer Support Experience.



Preconfigured

SPECIFICATIONS	21" Two-Seat		24" Two-Seat		21" Three-Seat		24" Three-Seat	
Dimensions are in inches								
<b>GUEST</b>								
Overall Height	34.5	34.5	34.5	34.5	34.5	34.5	34.5	34.5
Overall Width	47.19	53.19	69.85	78.85				
Overall Depth	26.5	26.5	26.5	26.5				
Arm Height (height of arms from floor)	25.75	25.75	25.75	25.75				
Arm Height (arm height from seat to top of arm)	7.25	7.25	7.25	7.25				
Width Between Arms	20.75	23.75	20.75	23.75				
Seat Width	21.75	24.75	21.75	24.75				
Seat Depth	19	19	19	19				
Seat Height	18.5	18.5	18.5	18.5				
Back Height	18.5	18.5	18.5	18.5				
Weight (wood)	61 lb	64 lb	89 lb	94 lb				
Weight (metal)	68 lb	71 lb	99 lb	104 lb				
Weight Capacity (per seat)	350 lb (wood) 500 lb (metal)	350 lb (wood) 500 lb (metal)	350 lb (wood) 500 lb (metal)	350 lb (wood) 500 lb (metal)				
COM* (back & seat) (with upholstered arm insert)	3.8 yd 4.75 yd	3.8 yd 5.3 yd	5.7 yd 7 yd	5.7 yd 7.8 yd				
COL* (back & seat) (with upholstered arm insert)	58.8 sq ft 77.8 sq ft	86.8 sq ft 112.4 sq ft	88.2 sq ft 117.8 sq ft	130.2 sq ft 168.4 sq ft				

\* Yardage requirements for COM and COL are for solid and non-directional fabrics. Additional material may be required for larger repeating patterns. Contact Customer Experience.



Patient 21"      Patient 24"      Patient 30"

SPECIFICATIONS	21"	24"	30"
Dimensions are in inches			
Overall Height	44	44	44
Overall Width	24.5	27.5	33.5
Overall Depth	26.5	26.5	26.5
Arm Height (height of arms from floor)	25.75	25.75	25.75
Arm Height (arm height from seat to top of arm)	7.25	7.25	7.25
Width Between Arms	20.75	23.75	29.75
Seat Width	21.75	24.75	30.75
Seat Depth	19	19	19
Seat Height	18.5	18.5	18.5
Back Height	28.5	28.5	28.5
Weight (wood)	37 lb	39 lb	52 lb
Weight (metal)	42 lb	44 lb	57 lb
Weight Capacity	350 lb (wood) 500 lb (metal)	350 lb (wood) 500 lb (metal)	750 lb
COM* (back & seat) (with upholstered arm insert)	2.8 yd 3.1 yd	2.8 yd 3.1 yd	3.8 yd 3.8 yd
COL* (back & seat) (with upholstered arm insert)	35 sq ft 49 sq ft	43.4 sq ft 49 sq ft	50 sq ft 57 sq ft

\* Yardage requirements for COM and COL are for solid and non-directional fabrics. Additional material may be required for larger repeating patterns. Contact Customer Experience.



Freespan Armless

SPECIFICATIONS	21" Two-Seat		24" Two-Seat		21" Three-Seat		24" Three-Seat	
Dimensions are in inches								
<b>GUEST BACK</b>								
Overall Height	34.5	34.5	34.5	34.5	34.5	34.5	34.5	34.5
Overall Width	46.39	52.39	68.27	77.27				
Overall Depth	26.5	26.5	26.5	26.5				
Arm Height (height of arms from floor)	25.75	25.75	25.75	25.75				
Arm Height (arm height from seat to top of arm)	7.25	7.25	7.25	7.25				
Width Between Arms	42.64	48.64	64.52	73.52				
Seat Width	21.75	24.75	21.75	24.75				
Seat Depth	19	19	19	19				
Seat Height	18.5	18.5	18.5	18.5				
Back Height	18.5	18.5	18.5	18.5				
Weight (wood)	76 lb	79 lb	99 lb	104 lb				
Weight (metal)	81 lb	84 lb	104 lb	109 lb				
Weight Capacity	525 lb	525 lb	750 lb	750 lb				
COM* (back & seat) (with upholstered arm insert)	3.8 yd 4.25 yd	4.3 yd 4.5 yd	5.6 yd 6 yd	5.9 yd 6.5 yd				
COL* (back & seat) (with upholstered arm insert)	58 sq ft 68 sq ft	73 sq ft 86 sq ft	88.2 sq ft 93 sq ft	93 sq ft 102 sq ft				

\* Yardage requirements for COM and COL are for solid and non-directional fabrics. Additional material may be required for larger repeating patterns. Contact Customer Experience.



Freespan



Start/Center/End

**SPECIFICATIONS**

Dimensions are in inches

GUEST BACK	21"		24"	
	Two-Seat	Two-Seat	Three-Seat	Three-Seat
Overall Height	34.5	34.5	34.5	34.5
Overall Width	47.28	53.28	70.03	79.03
Overall Depth	26.5	26.5	26.5	26.5
Arm Height (height of arms from floor)	25.75	25.75	25.75	25.75
Arm Height (arm height from seat to top of arm)	7.25	7.25	7.25	7.25
Width Between Arms	20.75	23.75	20.75	23.75
Seat Width	21.75	24.75	21.75	24.75
Seat Depth	19	19	19	19
Seat Height	18.5	18.5	18.5	18.5
Back Height	18.5	18.5	18.5	18.5
Weight (wood)	79 lb	82 lb	105 lb	110 lb
Weight (metal)	85 lb	88 lb	112 lb	117 lb
Weight Capacity	525 lb	525 lb	750 lb	750 lb
COM* (back & seat) (with upholstered arm insert)	3.8 yd 5 yd	4.3 yd 5.25 yd	5.6 yd 7.5 yd	5.9 yd 8 yd
COL* (back & seat) (with upholstered arm insert)	58 sq ft 83 sq ft	86 sq ft 88 sq ft	88.2 sq ft 122 sq ft	93 sq ft 130 sq ft

\* Yardage requirements for COM and COL are for solid and non-directional fabrics. Additional material may be required for larger repeating patterns. Contact Customer Experience.

**SPECIFICATIONS** Dimensions are in inches

START	21"		24"		30"		44"	
	Guest	Patient	Guest	Patient	Guest	Patient	Guest	Patient
Overall Height	34.5	44	34.5	44	34.5	44	34.5	44
Overall Width	24.5	24.5	27.5	27.5	33.5	33.5	47.5	47.5
Overall Depth	26.5	26.5	26.5	26.5	26.5	26.5	26.5	26.5
Arm Height (height of arms from floor)	25.75	25.75	25.75	25.75	25.75	25.75	25.75	25.75
Arm Height (arm height from seat to top of arm)	7.25	7.25	7.25	7.25	7.25	7.25	7.25	7.25
Width Between Arms	20.75	20.75	23.75	23.75	29.75	29.75	43.75	43.75
Seat Width	21.75	21.75	24.75	24.75	30.75	30.75	44.75	44.75
Seat Depth	19	19	19	19	19	19	19	19
Seat Height	18.5	18.5	18.5	18.5	18.5	18.5	18.5	18.5
Back Height	18.5	28.5	18.5	28.5	18.5	28.5	18.5	28.5
Weight (wood)	33 lb	37 lb	35 lb	39 lb	45 lb	52 lb	72 lb	72 lb
Weight (metal)	38 lb	42 lb	40 lb	44 lb	50 lb	57 lb	77 lb	77 lb
Weight Capacity (per seat)	350 lb (wood) 500 lb (metal)	350 lb (wood) 500 lb (metal)	350 lb (wood) 500 lb (metal)	350 lb (wood) 500 lb (metal)	750 lb	750 lb	750 lb	750 lb
COM* (back & seat) (with upholstered arm insert)	1.9 yd 2.5 yd	2.8 yd 3.1 yd	1.9 yd 2.8 yd	2.8 yd 3.1 yd	3.1 yd 3.1 yd	3.8 yd 3.8 yd	3.4 yd 4.1 yd	3.4 yd 4.1 yd
COL* (back & seat) (with upholstered arm insert)	29.4 sq ft 37.8 sq ft	35 sq ft 49 sq ft	43.4 sq ft 57.4 sq ft	43.4 sq ft 49 sq ft	47.6 sq ft 47.6 sq ft	50 sq ft 57 sq ft	50.4 sq ft 63 sq ft	50.4 sq ft 63 sq ft

\* Yardage requirements for COM and COL are for solid and non-directional fabrics. Additional material may be required for larger repeating patterns. Contact Customer Experience.

**CENTER**

Overall Height	34.5	44	34.5	44	34.5	44	34.5
Overall Width	22.66	22.66	25.66	25.66	31.66	31.66	45.66
Overall Depth	26.5	26.5	26.5	26.5	26.5	26.5	26.5
Arm Height (height of arms from floor)	25.75	25.75	25.75	25.75	25.75	25.75	25.75
Arm Height (arm height from seat to top of arm)	7.25	7.25	7.25	7.25	7.25	7.25	7.25
Width Between Arms	20.75	20.75	23.75	23.75	29.75	29.75	43.75
Seat Width	21.75	21.75	24.75	24.75	30.75	30.75	44.75
Seat Depth	19	19	19	19	19	19	19
Seat Height	18.5	18.5	18.5	18.5	18.5	18.5	18.5
Back Height	18.5	28.5	18.5	28.5	18.5	28.5	18.5
Weight (wood)	33 lb	37 lb	35 lb	39 lb	45 lb	52 lb	72 lb
Weight (metal)	38 lb	42 lb	40 lb	44 lb	50 lb	57 lb	77 lb
Weight Capacity (per seat)	350 lb (wood) 500 lb (metal)	350 lb (wood) 500 lb (metal)	350 lb (wood) 500 lb (metal)	350 lb (wood) 500 lb (metal)	750 lb	750 lb	750 lb
COM* (back & seat) (with upholstered arm insert)	1.9 yd 2.25 yd	2.8 yd 2.8 yd	1.9 yd 2.5 yd	2.8 yd 3.1 yd	3.1 yd 3.1 yd	3.8 yd 3.8 yd	3.4 yd 3.5 yd
COL* (back & seat) (with upholstered arm insert)	29.4 sq ft 40 sq ft	35 sq ft 49 sq ft	43.4 sq ft 55 sq ft	43.4 sq ft 49 sq ft	47.6 sq ft 47.6 sq ft	50 sq ft 57 sq ft	50.4 sq ft 60 sq ft

\* Yardage requirements for COM and COL are for solid and non-directional fabrics. Additional material may be required for larger repeating patterns. Contact Customer Experience.

**END**

Overall Height	34.5	44	34.5	44	34.5	44	34.5
Overall Width	22.66	22.66	25.66	25.66	31.66	31.66	45.66
Overall Depth	26.5	26.5	26.5	26.5	26.5	26.5	26.5
Arm Height (height of arms from floor)	25.75	25.75	25.75	25.75	25.75	25.75	25.75
Arm Height (arm height from seat to top of arm)	7.25	7.25	7.25	7.25	7.25	7.25	7.25
Width Between Arms	20.75	20.75	23.75	23.75	29.75	29.75	43.75
Seat Width	21.75	21.75	24.75	24.75	30.75	30.75	44.75
Seat Depth	19	19	19	19	19	19	19
Seat Height	18.5	18.5	18.5	18.5	18.5	18.5	18.5
Back Height	18.5	28.5	18.5	28.5	18.5	28.5	18.5
Weight (wood)	33 lb	37 lb	35 lb	39 lb	45 lb	52 lb	72 lb
Weight (metal)	38 lb	42 lb	40 lb	44 lb	50 lb	57 lb	77 lb
Weight Capacity (per seat)	350 lb (wood) 500 lb (metal)	350 lb (wood) 500 lb (metal)	350 lb (wood) 500 lb (metal)	350 lb (wood) 500 lb (metal)	750 lb	750 lb	750 lb
COM* (back & seat) (with upholstered arm insert)	1.9 yd 2.25 yd	2.8 yd 2.8 yd	1.9 yd 2.5 yd	2.8 yd 3.1 yd	3.1 yd 3.1 yd	3.8 yd 3.8 yd	3.4 yd 3.5 yd
COL* (back & seat) (with upholstered arm insert)	29.4 sq ft 40 sq ft	35 sq ft 49 sq ft	43.4 sq ft 55 sq ft	43.4 sq ft 49 sq ft	47.6 sq ft 47.6 sq ft	50 sq ft 57 sq ft	50.4 sq ft 60 sq ft

\* Yardage requirements for COM and COL are for solid and non-directional fabrics. Additional material may be required for larger repeating patterns. Contact Customer Experience.



# Point, click and customize with ChairBuilder+.

Create your very own seating solutions with the industry-leading specification and visualization tool. See your designs come to life in real-time with 360-degree, high-resolution images and access to our extensive collection of carded textiles. Plus, ChairBuilder+ also includes access to our modular lounge configurator with intuitive snap-logic and 2D and 3D viewing options.

Ready to give it a try? Visit [www.ChairBuilder.com](http://www.ChairBuilder.com) to get started.



**SitOnIt • Seating®**

*FRONT COVER TEXTILES:  
Aviera: SitOnIt Seating Collection Sil-Tex Original Mist (seat), DesignTex Leap Tide Pool (back)  
Nano: SitOnIt Seating Collection Newport Seafoam (chassis), Uptown Walnut Laminate (top)*